

- NOTICE -

THIS DOCUMENT CONTAINS PROPRIETARY INFORMATION OF DANFOSS DRIVES. IT IS LOANED BY DANFOSS DRIVES SUBJECT TO THE CONDITIONS THAT IT AND THE INFORMATION EMBODIED THEREIN SHALL BE USED ONLY FOR RECORD AND REFERENCE PURPOSES, SHALL NOT BE USED OR CAUSED TO BE USED IN ANY WAY PREJUDICIAL TO THE INTERESTS OF DANFOSS DRIVES, SHALL NOT BE REPRODUCED OR COPIED IN WHOLE OR IN PART OR DISCLOSED TO ANYONE WITHOUT THE DIRECT WRITTEN PERMISSION OF DANFOSS DRIVES, AND SHALL BE RETURNED UPON REQUEST.

REVISION HISTORY

REV	ECN NUMBER	ENTRY BY	DATE
001	INITIAL RELEASE	PK	01/25/12

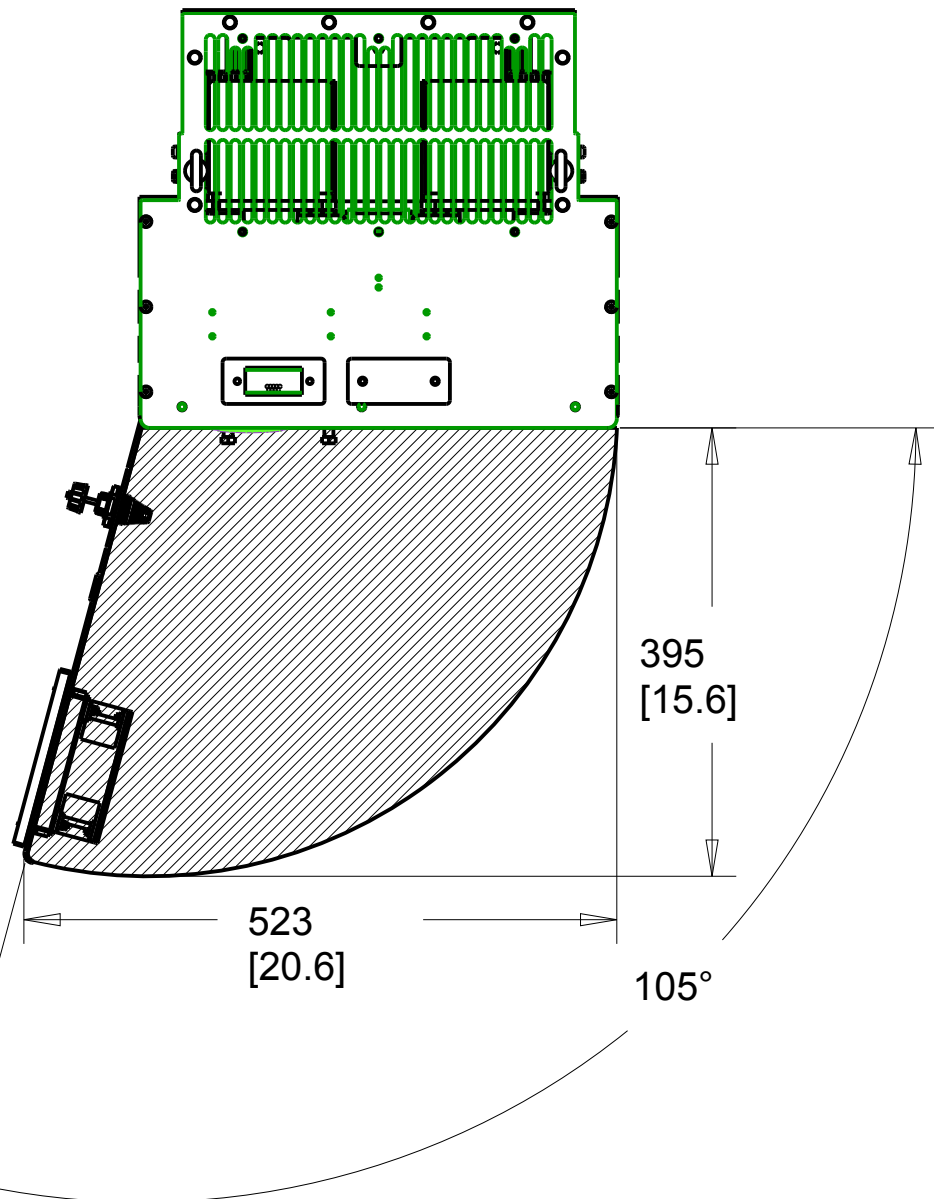
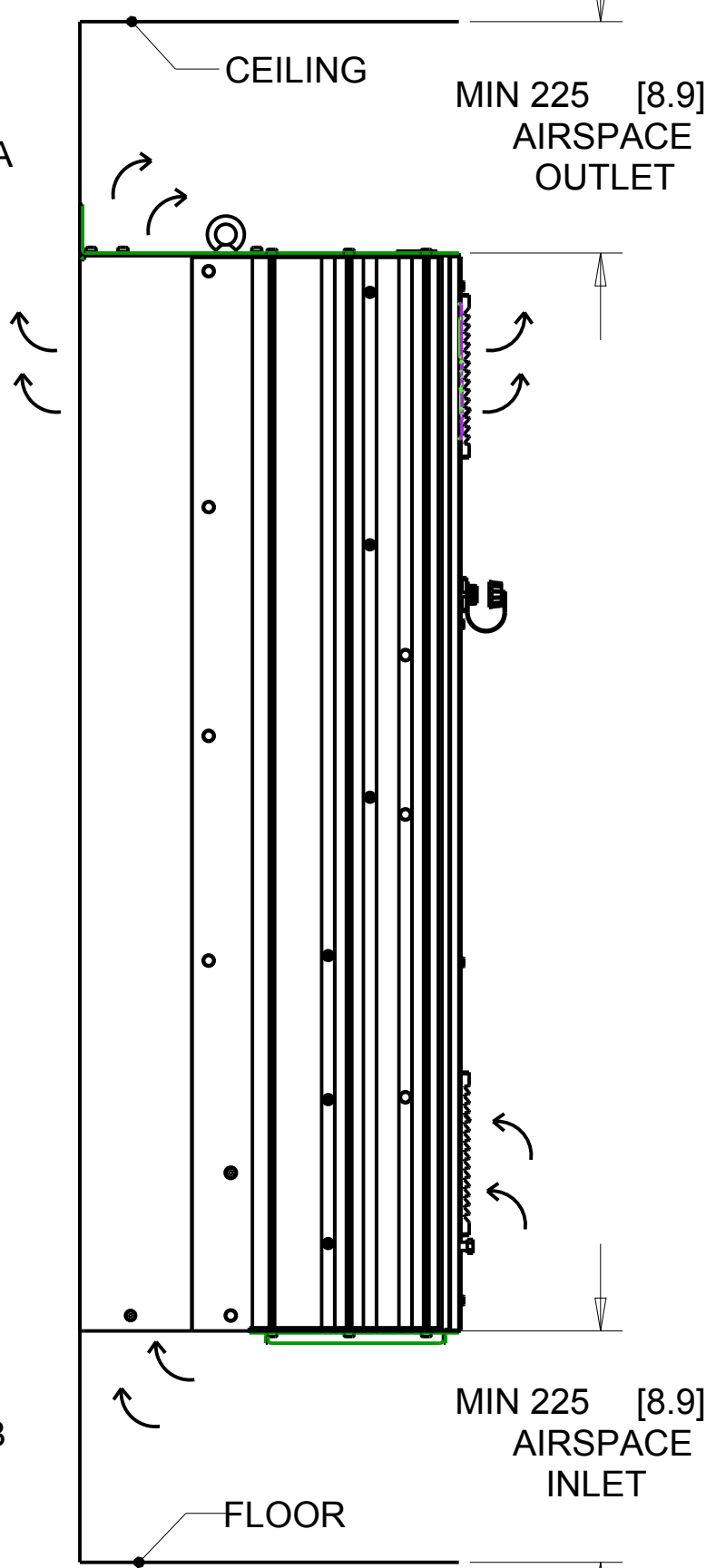
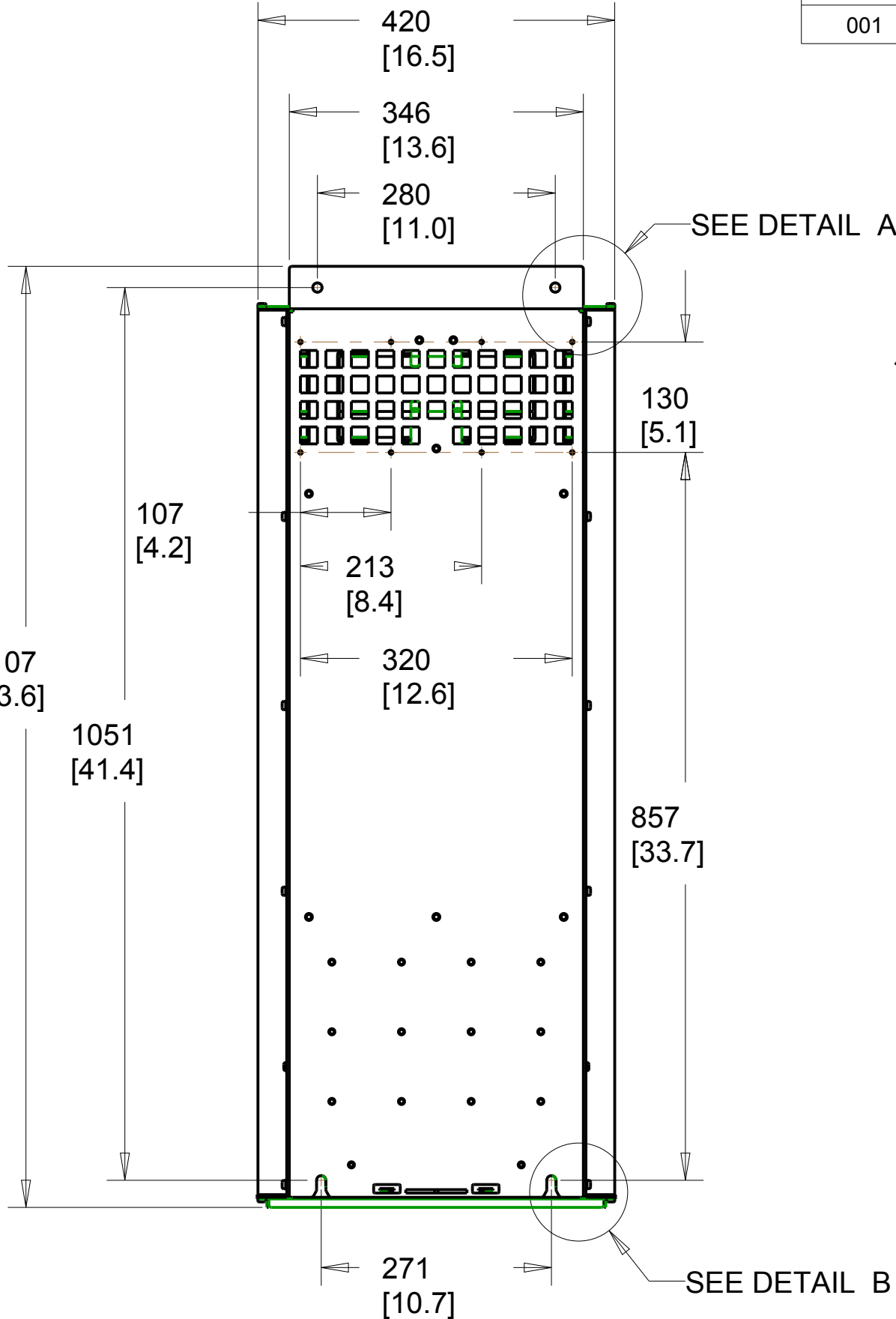
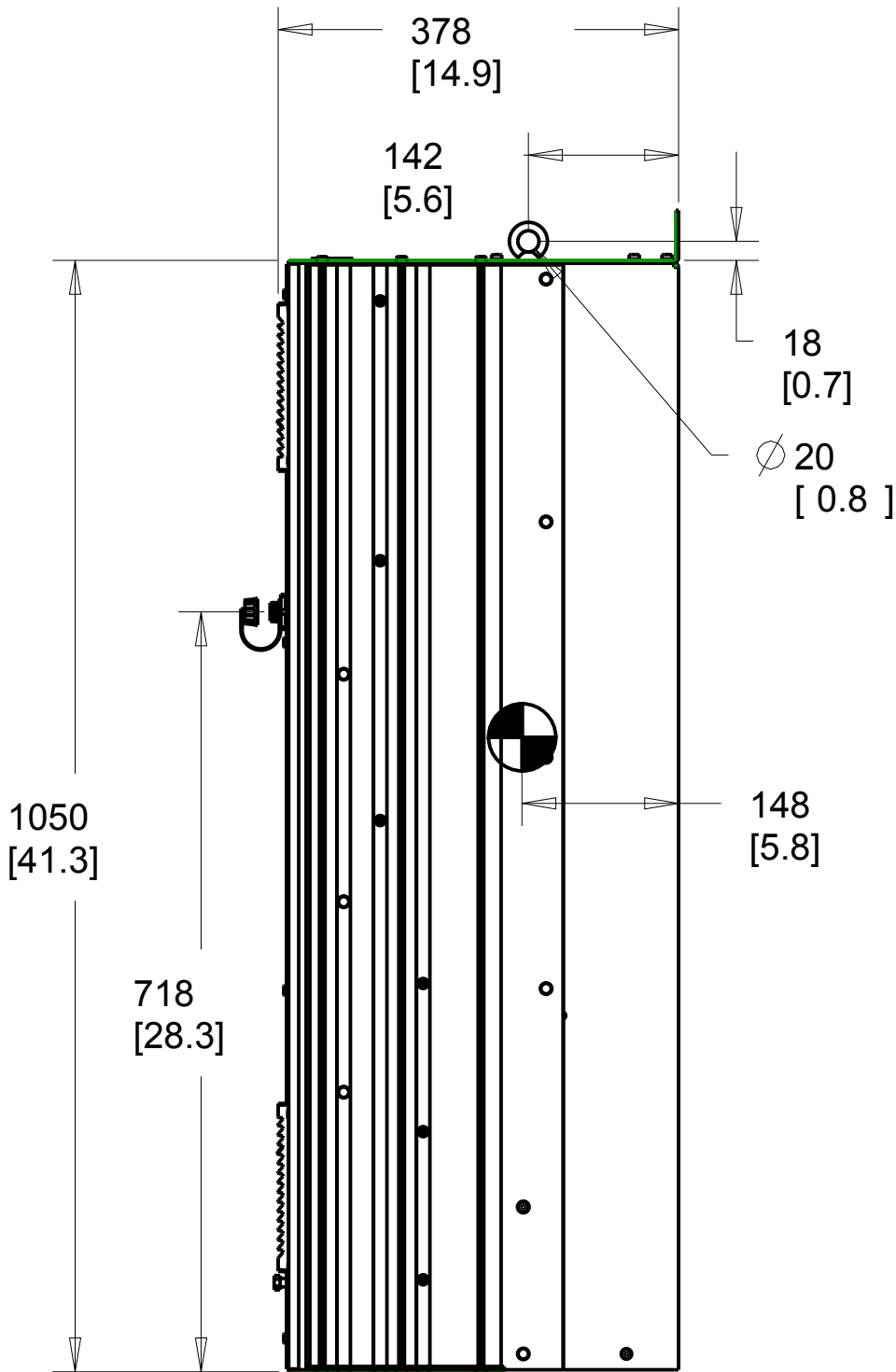
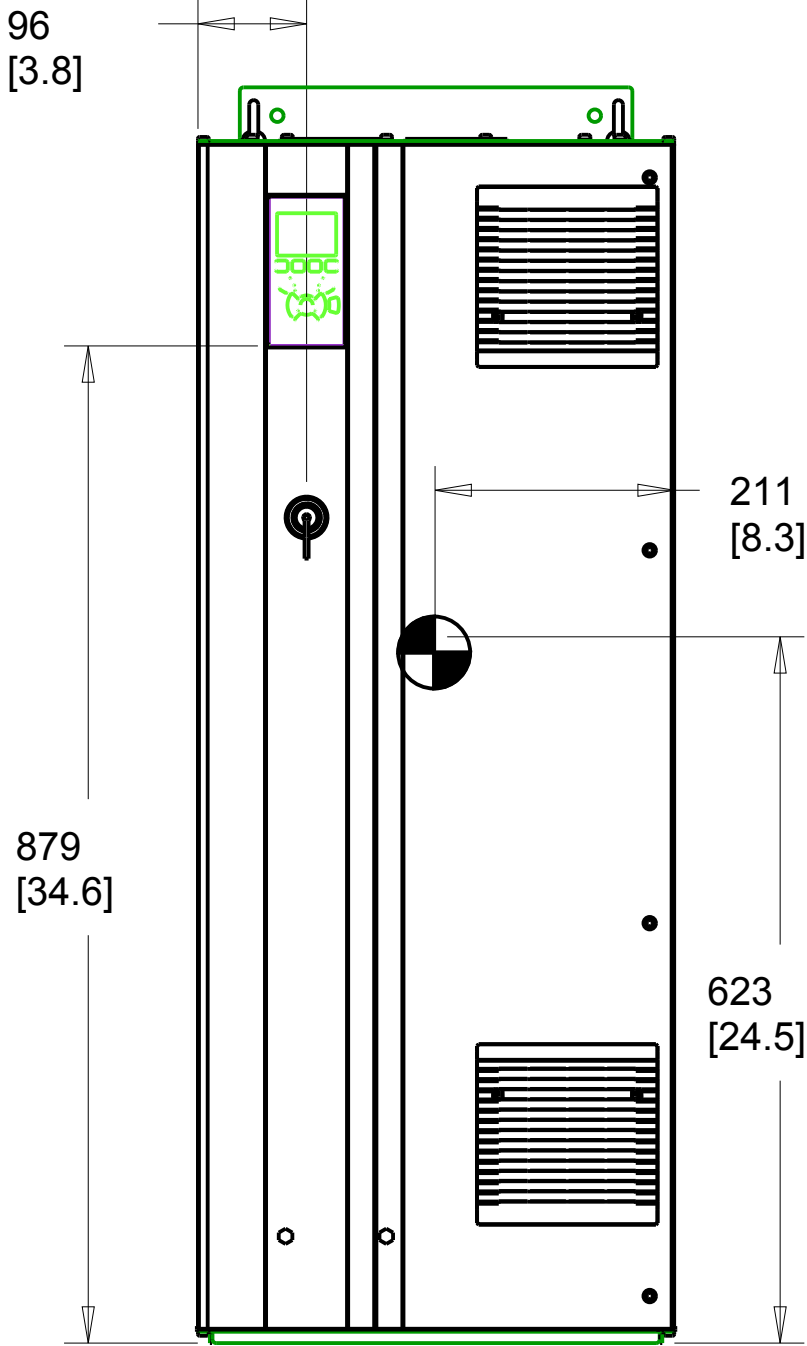

DETAIL A

USE M10 MTG BOLT OR  
3/8" MTG BOLT

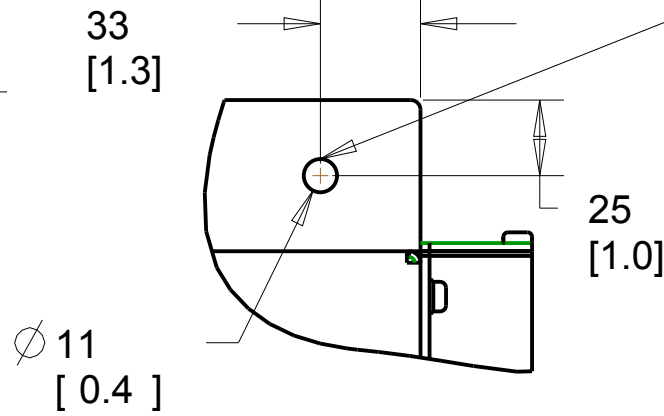

DETAIL B

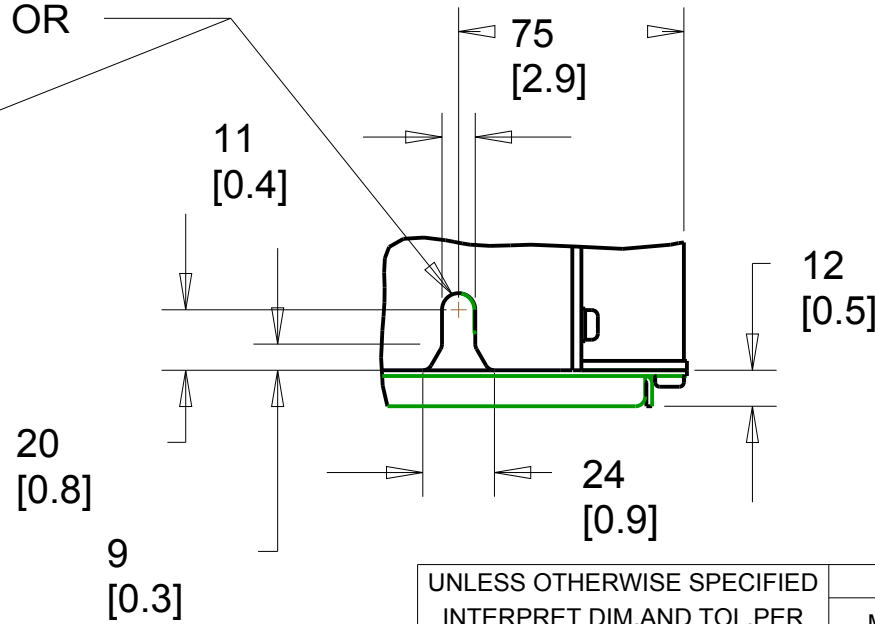

1. MAX AIRFLOW (BACKCHANNEL) - 14 M³ / MIN (500 CFM)
2. MAX AIRFLOW (CABINET) - 3.4 M³ / MIN (120 CFM)
3. MAX WEIGHT = 125 KG (275 LBS)
4. CENTER OF GRAVITY:  
APPROXIMATE LOCATION ONLY, LOCATION MAY VARY BASED ON POWER RATING AND OPTIONS ORDERED.

UNLESS OTHERWISE SPECIFIED  
INTERPRET DIM AND TOL. PER  
ASME Y14.5M-1994

.X± 0.4 .XX± 0.2 ∠ ± 0.5

DIM. ARE IN MILLIMETERS  
WEIGHTS ARE IN KILOGRAMS

THIRD ANGLE PROJECTION

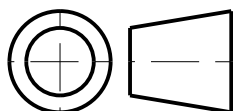

PROPERTIES

MATERIAL	N/A	
FINISH	N/A	
THICKNESS	N/A	
ST.WEIGHT	125	
APPROVALS	INITIALS	DATE
DRAWN	CCN	06/16/11
CHECKED		
ENGR		

**Danfoss**

4401 N. BELL SCHOOL RD. LOVES PARK, ILLINOIS 61111 USA  
(815) 639-8600 FAX (815) 639-8000

INSTALLATION DRAWING, D2H, IP21/54

SIZE	C	MODEL	REV
SCALE	0.150	DRAWING NO.	001
			SHEET
			1 OF 3

# SECTION A-A MAINS TERMINALS

# SECTION B-B MOTOR TERMINALS

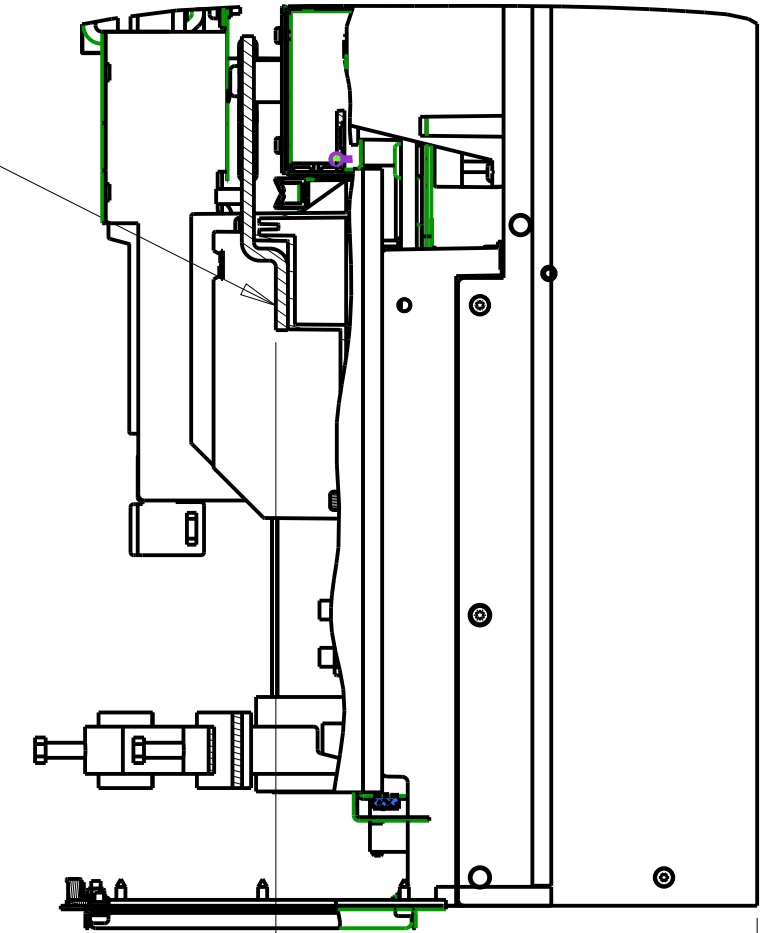
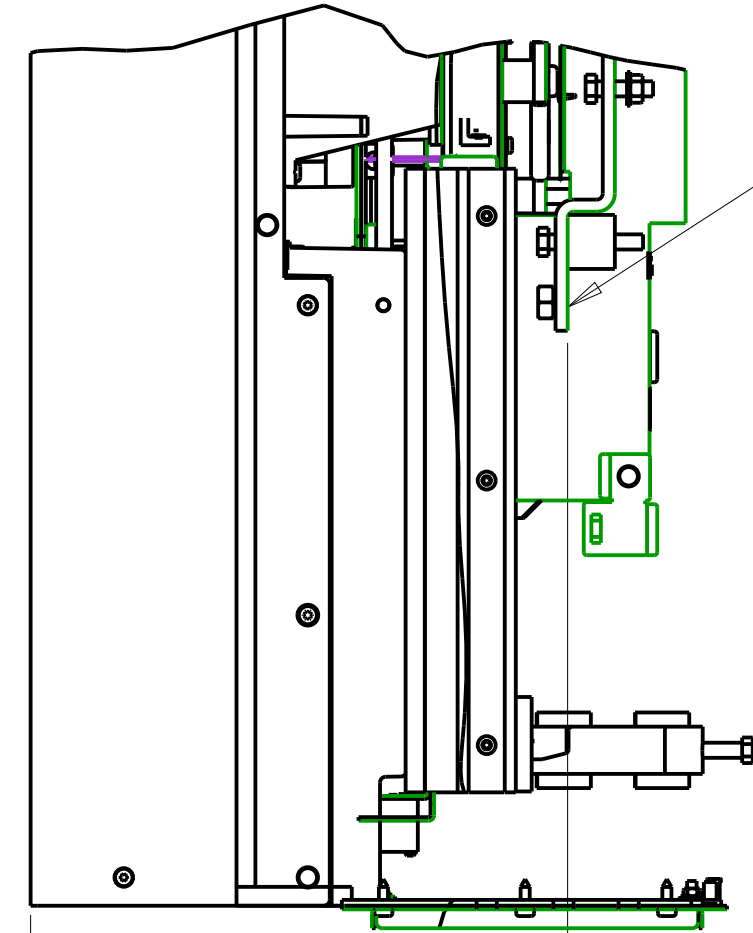

MAINS TERMINAL

MOTOR TERMINAL

331  
[ 13.0 ]

4X M10X20 STUD  
WITH NUT

GROUND 168  
[ 6.6 ]

GROUND 143  
[ 5.6 ]

211  
[ 8.3 ]

GROUND 168  
[ 6.6 ]

GROUND 143  
[ 5.6 ]

0  
[ 0.0 ]

42  
[ 1.7 ]

378  
[ 14.9 ]

68  
[ 2.7 ]

184  
[ 7.2 ]

299.8  
[ 12 ]

126  
[ 5.0 ]

245.8  
[ 9.7 ]

354  
[ 13.9 ]

255  
[ 10.0 ]

0  
[ 0.0 ]

MAINS TERMINAL

MOTOR TERMINAL

15  
[ 0.6 ]

M10

19  
[ 0.8 ]

38  
[ 1.5 ]

15  
[ 0.6 ]

M10

18  
[ 0.7 ]

35.0  
[ 1.4 ]

27  
[ 1.0 ]

MAINS SIDE  
CABLE ENTRY

145  
[ 5.7 ]

196  
[ 7.7 ]

369  
[ 14.5 ]

185  
[ 7.3 ]

MOTOR SIDE  
CABLE ENTRY

BOTTOM VIEW

NOTES:

1. PLACE CABLES THROUGH MARKED AREAS
2. 185MM<sup>2</sup> (400 MCM) MAX WIRE SIZE

TITLE		
INSTALLATION DRAWING, D2H, IP21/54		
SIZE C	MODEL	REV 001
SCALE 0.250	DRAWING NO. 177R0375	SHEET 2 OF 3

4		3		2		1																																																		
D	THE TABLES BELOW MAY BE USED TO CONFIRM THE CORRECT FRAME SIZE AND DRAWING FOR A SPECIFIC DRIVE RATING (POWER AND VOLTAGE). THIS DRAWING IS FOR D2H FRAMES, THE TABLES BELOW IDENTIFY WHICH DRIVES ARE REPRESENTED BY THIS DRAWING.						D																																																	
C	<table><tr><th colspan="7">KW RATED DRIVES</th></tr><tr><td>KW HIGH OVERLOAD</td><td>132</td><td>160</td><td>200</td><td>250</td><td>315</td><td>315</td></tr><tr><td>KW NORMAL OVERLOAD</td><td>160</td><td>200</td><td>250</td><td>315</td><td>355</td><td>400</td></tr><tr><td>400V</td><td></td><td>D2H</td><td>D2H</td><td>D2H</td><td></td><td></td></tr><tr><td>500V</td><td></td><td></td><td>D2H</td><td>D2H</td><td>D2H</td><td></td></tr><tr><td>525V</td><td>D2H</td><td>D2H</td><td>D2H</td><td>D2H</td><td></td><td></td></tr><tr><td>690V</td><td></td><td>D2H</td><td>D2H</td><td>D2H</td><td></td><td>D2H</td></tr></table>						KW RATED DRIVES							KW HIGH OVERLOAD	132	160	200	250	315	315	KW NORMAL OVERLOAD	160	200	250	315	355	400	400V		D2H	D2H	D2H			500V			D2H	D2H	D2H		525V	D2H	D2H	D2H	D2H			690V		D2H	D2H	D2H		D2H	C
	KW RATED DRIVES																																																							
KW HIGH OVERLOAD	132	160	200	250	315	315																																																		
KW NORMAL OVERLOAD	160	200	250	315	355	400																																																		
400V		D2H	D2H	D2H																																																				
500V			D2H	D2H	D2H																																																			
525V	D2H	D2H	D2H	D2H																																																				
690V		D2H	D2H	D2H		D2H																																																		
B	<table><tr><th colspan="6">HORSEPOWER RATED DRIVES</th></tr><tr><td>HP HIGH OVERLOAD</td><td>200</td><td>250</td><td>300</td><td>350</td><td>350</td></tr><tr><td>HP NORMAL OVERLOAD</td><td>250</td><td>300</td><td>350</td><td>400</td><td>450</td></tr><tr><td>460V</td><td></td><td>D2H</td><td>D2H</td><td></td><td>D2H</td></tr><tr><td>575V</td><td>D2H</td><td>D2H</td><td>D2H</td><td>D2H</td><td></td></tr></table>						HORSEPOWER RATED DRIVES						HP HIGH OVERLOAD	200	250	300	350	350	HP NORMAL OVERLOAD	250	300	350	400	450	460V		D2H	D2H		D2H	575V	D2H	D2H	D2H	D2H		B																			
	HORSEPOWER RATED DRIVES																																																							
HP HIGH OVERLOAD	200	250	300	350	350																																																			
HP NORMAL OVERLOAD	250	300	350	400	450																																																			
460V		D2H	D2H		D2H																																																			
575V	D2H	D2H	D2H	D2H																																																				
A							A																																																	
4		3		2		1																																																		
						<table><tr><th colspan="3">TITLE</th></tr><tr><td colspan="3">INSTALLATION DRAWING, D2H, IP21/54</td></tr><tr><td>SIZE</td><td>MODEL</td><td>REV</td></tr><tr><td>C</td><td></td><td>001</td></tr><tr><td>SCALE</td><td>DRAWING NO.</td><td>SHEET</td></tr><tr><td>0.150</td><td>177R0375</td><td>3 OF 3</td></tr></table>		TITLE			INSTALLATION DRAWING, D2H, IP21/54			SIZE	MODEL	REV	C		001	SCALE	DRAWING NO.	SHEET	0.150	177R0375	3 OF 3																															
TITLE																																																								
INSTALLATION DRAWING, D2H, IP21/54																																																								
SIZE	MODEL	REV																																																						
C		001																																																						
SCALE	DRAWING NO.	SHEET																																																						
0.150	177R0375	3 OF 3																																																						
4		3		2		1																																																		

PLATFORM	VOLTAGE	MODEL/TYPECODE	FRAME(IP21/IP54)
HVAC	T4	FC-102N200T4	D2H
		FC-102N250T4	
		FC-102N315T4	
	T7	FC-102N200T7	
		FC-102N250T7	
		FC-102N315T7	
		FC-102N400T7	
AQUA	T4	FC-202N200T4	
		FC-202N250T4	
		FC-202N315T4	
	T7	FC-202N200T7	
		FC-202N250T7	
		FC-202N315T7	
		FC-202N400T7	
AUTOMATION	T5	FC-302N160T5	
		FC-302N200T5	
		FC-302N250T5	
	T7	FC-302N160T7	
		FC-302N200T7	
		FC-302N250T7	
		FC-302N315T7	